

PRODUCT MANUAL

MANDOLIN TWIN FUSION

Thank you for choosing the Mandolin Twin Fusion! This pickup system can easily be installed by the musician. It provides the same great sound as the fully internal Mandolin Twin System offered by K&K Sound but it does not require any permanent alteration to your instrument.

We recommend a K&K Pure Preamp or a K&K Pure XLR Preamp with this setup in order to have great sound with any amp/PA and in any situation.

INSTALLATION

1. The picture shows the desired locations of the two transducers inside the mandolin. In some models the two braces will run differently than shown here.

If a brace does not allow you to place the pickup next to the exact center (the widest part) of the F hole, just move the pickup up or down a bit until you find a spot that fits the transducer. However, move it a little as possible from the position shown.

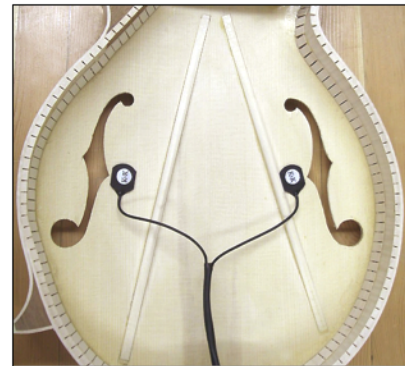

2. The materials you will need for installation, from left to right: Scissors, tweezers (if you do not have tweezers handy, a pair of small needle-nose pliers will work just fine). In the sales package, locate the bent nail (this is your installation tool), the putty piece (gray putty on brown/white paper), the double-stick tape (on brown/white paper), and, of course, the pickup.

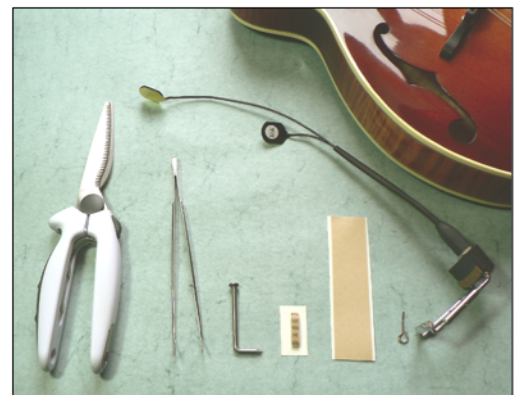

3. Apply double stick tape to the golden side of the transducers, it is a very thin film:



We recommend applying two layers of the double stick tape. After the first layer is applied as shown, peel off the brown protective tape. Repeat the procedure. This helps to reduce the sensitivity towards unwanted mechanical transmissions and guarantees the most secure adhesion.

4. Put the transducers into the treble side F-hole. If you have a pick-guard, remove it temporarily.

Maneuver the bass side pickup over to the bass side F-hole, and fish it out with tweezers or needle-nose pliers.

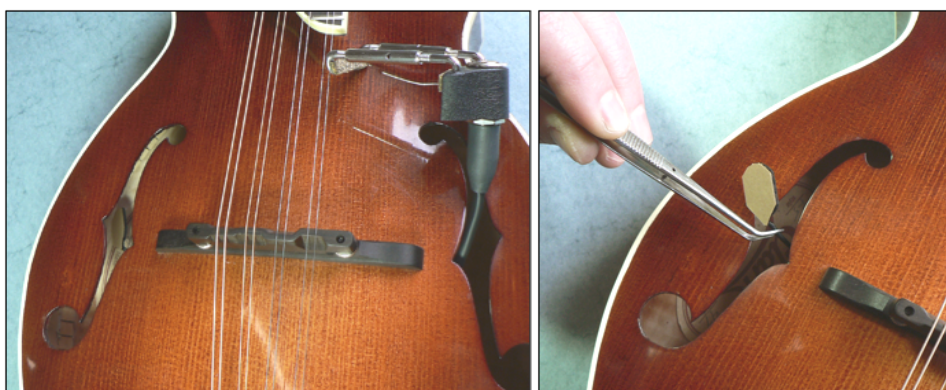

5. Locate the putty piece and form a round ball from it.

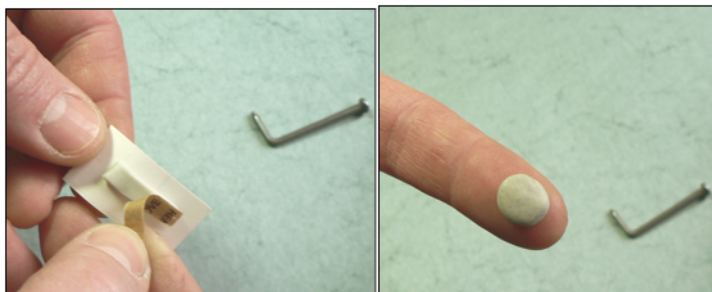

6. Stick the putty over the bent nail (your installation tool) onto the labeled-black side of the pickup. Make sure to hold the pickup so the cable leads towards the bottom of the mandolin once the pickup is attached to the soundboard. The putty will temporarily hold the pickup to the bent nail.

Test if the brace inside the mandolin allows free access to the pickup's desired location. By holding on to the nail you can carefully move the pickup around inside the mandolin and test the fit. Aim for a spot next to the widest part of the F hole, closest to the bridge.

Once you've established the desired spot make sure the putty still securely adheres to the pickup. It can be re-shaped and re-positioned if needed.



-
7. Remove the brown protective paper from the double stick tape on the pickup and bring the pickup into position.



-
8. Use upward pressure on the installation tool to firmly press the pickup to the soundboard.



9. Carefully remove the installation tool. It should come off with the putty on it. If part of the putty stuck to the pickup, you can try to remove it with your pinky finger but it does not affect performance if you leave it on the pickup.

Once you removed the tool, remove the putty from it and save the putty to install the other pickup.

Use the installation tool (without putty) to apply more upward pressure to the pickup in order to ensure secure adhesion.



10. Now the first pickup is properly installed. It's time to fish the treble pickup out of the treble F-hole.



11. Use the same technique with the installation tool and the putty as before, again making sure the cable is pointing towards the bottom of the mandolin.

Once you've established the desired spot for the pickup, make sure the putty still securely adheres to the pickup.

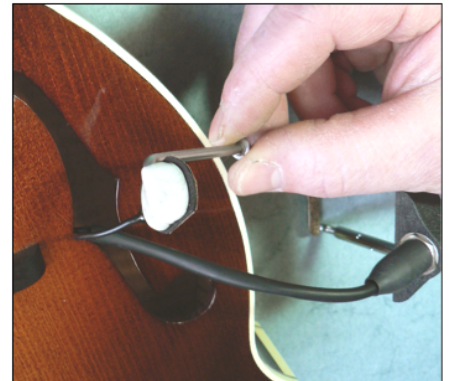

12. Remove the brown protective paper from the double stick tape on the pickup and bring the pickup into position. Use upward pressure on the installation tool to firmly press the pickup to the soundboard.

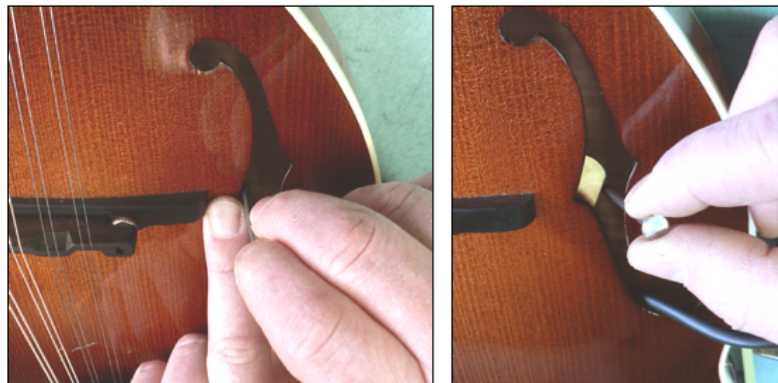

13. Carefully remove the installation tool. Again, it should come off with the putty on it.

Once you removed the tool, remove the putty from it and use the installation tool (without putty) to apply more upward pressure to different areas of the pickup to ensure secure adhesion.

Now both transducers are successfully installed. All that is left is fastening the carpenter jack clamp.



14. Bring the carpenter jack in position and use use a fitting tool (like a small Allen wrench that fits the holes in the barrel screws) to tighten the clamp as shown.

Once it is secure, make sure the cable is aligned properly over the edge of the F hole (see picture) and the cables inside the instrument are free and not touching the mandolin.



REMOVING PICKUPS

If you need to remove this pickup after installation, please **do not use any kind of chemical or solvent on the pickup!** This includes products like acetone, Goo-Gone, super glue remover, rubbing alcohol, WD-40, or similar.

Using any kind of solvent will de-laminate and destroy the pickup.

We recommend the following procedure for removing the pickup(s):
Slide a razor blade or slim knife under the pickup and carefully lift it off.
Rub off any remaining adhesive on the pickup with your thumb, or with fine sandpaper.